

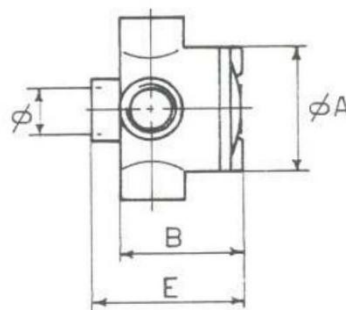

## ESPECIFICACIONES TÉCNICAS

|                            |   |
|----------------------------|---|
| <b>Certificado:</b>        | ATEX: CESI 02 ATEX 091<br>IEC Ex: CES 14.0018X<br>INMETRO: DNV 14.0108  |
| <b>Certificación:</b>      | II 2 GD - Ex d IIC T... Gb - Ex tb IIIC T... Db - IP66/67<br>II 2 GD - Ex e IIC T... Gb - Ex tb IIIC T... Db - IP66/67<br>II 2 GD - Ex i IIC T... Gb - Ex tb IIIC T... Db - IP66/67 |
| <b>Temperatura:</b>        | -40°C < T <sub>a</sub> < +40°C  |
| <b>Material:</b>           | Aleación de aluminio con bajo contenido en cobre.<br>Tornillería de acero inoxidable  |
| <b>Tensión nominal:</b>    | 750 V   |
| <b>Frecuencia nominal:</b> | 50 - 60 Hz  |

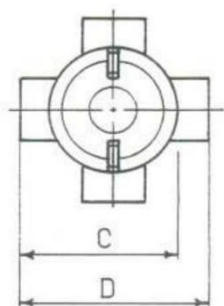

| Referencia | Entradas    |            | Dimensiones (mm) |     |     |     | Peso (Kg) |
|------------|-------------|------------|------------------|-----|-----|-----|-----------|
|            | Disposición | Rosca      | B                | C   | D   | A   |           |
| GUAB-26    |             | 3/4" NPT   | 65               | 110 | 125 | 90  | 0,45      |
| GUAB-36    |             | 1" NPT     | 70               | 120 | 140 | 90  | 0,50      |
| GUAB-59    |             | 1 1/2" NPT | 95               | 180 | 205 | 159 | 2,00      |
| GUAB-69    |             | 2" NPT     | 95               | 180 | 205 | 159 | 1,67      |
| GUAC-26    |             | 3/4" NPT   | 65               | 110 | 125 | 90  | 0,45      |
| GUAC-36    |             | 1" NPT     | 70               | 120 | 140 | 90  | 0,50      |
| GUAC-59    |             | 1 1/2" NPT | 95               | 180 | 205 | 159 | 2,00      |
| GUAC-69    |             | 2" NPT     | 95               | 180 | 205 | 159 | 1,67      |
| GUAT-26    |             | 3/4" NPT   | 65               | 110 | 125 | 90  | 0,45      |
| GUAT-36    |             | 1" NPT     | 70               | 120 | 140 | 90  | 0,50      |
| GUAT-59    |             | 1 1/2" NPT | 95               | 180 | 205 | 159 | 2,00      |
| GUAT-69    |             | 2" NPT     | 95               | 180 | 205 | 159 | 1,67      |
| GUAX-26    |             | 3/4" NPT   | 65               | 110 | 125 | 90  | 0,45      |
| GUAX-36    |             | 1" NPT     | 70               | 120 | 140 | 90  | 0,50      |
| GUAX-59    |             | 1 1/2" NPT | 95               | 180 | 205 | 159 | 2,00      |
| GUAX-69    |             | 2" NPT     | 95               | 180 | 205 | 159 | 1,67      |